

**seppi m.**<sup>®</sup>

MULCHING EQUIPMENT SPECIALISTS

Flail Mulchers  
SMW · SMO

# Flail Mulchers

20-120 HP



"Mulchers are a long-term investment.  
It is important to us that you remain satisfied with your mulcher."

SEPPI M. SpA

### Our Commitment

- > Founded in 1939, we have specialized in manufacturing mulchers since 1971
- > Regardless of the manufacturer or brand, we only choose materials and products that meet our rigorous quality criteria
- > Continuous research and development
- > High quality and optimal service

### Your Advantages

- > Reliable equipment as the result of years of experience in the sector
- > High quality materials to take on the harshest work conditions and guarantee maximum durability
- > Advanced technology for an investment for the future
- > Consulting and after sales service: You can rely on us!

### Rotors and Tools

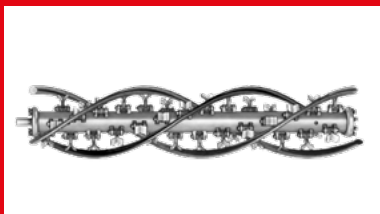

Triple helical rotor  
> better power distribution, low noise and vibration.  
Holders made of forged and tempered steel, high strength screws and heads  
> ensures high wear resistance.

HELIX ROTOR  
XXXXXXXXXX

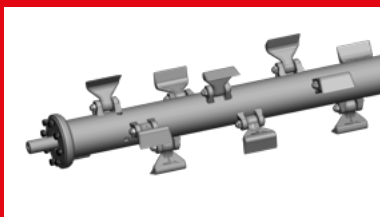

Rotor with powerful flails for mulching grass and brush, made of forged steel >self-sharpening and wear-resistant.

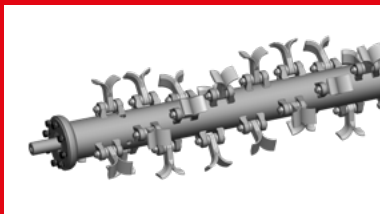

Rotor with a large number of Y-blades for mulching grass and brushwood.

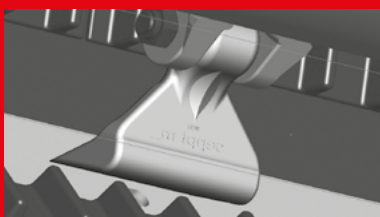

Robust chassis made of high tensile steel with tempered counter cutters for a perfect mulching result.



2 COUNTER CUTTERS

## Flail Mulchers

 20-120 HP

Find the machine according to your application here.

Since 1971 SEPPi flail mowers have been working to satisfy professionals in agriculture and greenspace maintenance. Strength and reliable performance, both in grass and wood, saves time and costs compared to less professional machines. With a vast range of options and accessories, every machine can be equipped to meet specific professional needs, individual requirements or working conditions.

The following mulchers are designed for tractors with a nominal power of 20-120 HP. They mulch grass and prunings up to 7 cm [3"] in diameter.

Mulchers for 80-250 HP tractors and applications for up to 11 cm [4"] in diameter are compiled in a separate brochure.

### Versatility of SEPPi M. mulchers

















Open rear hood:  
mulching grass with low  
power consumption



Closed rear hood:  
mulching fine prunings and  
brushes



Working width cm [inch]												Model · Weight <sup>1</sup> · Tractor <sup>2</sup>																
37	41	45	49	53	57	59	61	69	79	89	98	108	95	105	115	125	135	145	155	175	200	225	250	275	linkage	side shift	tools	Ø max
																									rear	-	 	3 cm [1.2"]
																									reversible	manual 2 positions	 	5 cm [2"]
																									reversible	linear hydraulic	 	5 cm [2"]
																									reversible	linear hydraulic		5 cm [2"]
																									rear	parallel/manual to the right option: hydraulic	 	5 cm [2"]
																									rear	parallel/manual to the right or left option: hydraulic	 	7 cm [2.8"]
																									reversible	-	 	7 cm [2.8"]
																									reversible	linear hydraulic	 	7 cm [2.8"]

<sup>1</sup> standard version without options

<sup>2</sup> tractor nominal power

# 2-FAST

Attachments: XSC · XSA · XSP · XDF · XAN · XID

Equipment for undercanopy maintenance (optional accessories)

In order to keep the orchards clean, SEPPI M. offers a spraying system as well as several mechanical attachments for organic farming. The accessories are connected to the mulcher with the quick coupling system 2-FAST - available with or without direct hydraulics.

The several equipments and their use are listed below.

Attachments with quick coupling system

- > The **outrigger XSC** is specialized for inter-row mowing. The double XSC outrigger also adapts to row widths. This makes mowing much faster and more efficient.
- > The **cultivator XSA** supports organic agriculture. A mechanical process cuts the roots of weeds and brings them to the surface.
- > The brushes of the **shoot removers XSP and XDF** clean the trunk and remove shoot, suckers and straw mechanically – without chemicals.



Other accessories for undercanopy maintenance

- > The **sweeper XAN** collects leaves and prunings from row sides and bring them into an ideal position for mulching: in front of the mulching mower.
- > The **herbicide spraying system XID** can be mounted to a SEPPI mulcher or a rotary mower. High-precision nozzles come with adjustable spraying direction.

For details, refer to the brochure "Equipment for Undercanopy Maintenance".



 [www.youtube.com/seppimulcher](https://www.youtube.com/seppimulcher)

# SML

20-50 HP Ø max. 3 cm [1.2 inch]

## Lightweight mulcher for light tractors

The SML flail mower is ideal for low nominal power tractors. Several options are available for the machine, guaranteeing a perfect result, whatever the conditions.



## Standard version and characteristics

- > Mulches grass and brush up to 3 cm [1.2"]Ø
- > Working speed 3-10 km/h
- > 3 point rear linkage cat. 1&2 central fixed
- > 540 rpm gearbox with freewheel
- > Belt transmission
- > Front protection: metal flaps
- > Rear protection: rubber flap
- > Support roller 133 mm [52"] Ø
- > Standard rotor with SMW flails optionally with Y flails



Height-adjustable support roller



Metal flaps in the front and rubber protection in the back protect tractor and driver

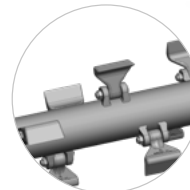

Standard rotor with SMW flails

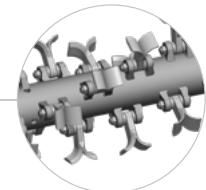

Optional rotor with Y flails

HELIX ROTOR

Low power consumption at maximum throughput with HELIX ROTOR technology

### Specifications · SML

		105 [41]	125 [49]	155 [61]	175 [69]	200 [79]
Working width	cm [inch]	105 [41]	125 [49]	155 [61]	175 [69]	200 [79]
Overall width	cm [inch]	125 [49]	145 [57]	175 [69]	195 [77]	220 [87]
Depth	cm [inch]	90 [35]	90 [35]	90 [35]	90 [35]	90 [35]
Height	cm [inch]	95 [37]	95 [37]	95 [37]	95 [37]	95 [37]
Weight (base value)	kg [lb]	265 [580]	290 [640]	330 [720]	350 [770]	380 [840]
Belts	qty	3	3	3	3	3
Flails	qty	9	12	15	18	21
Y flails	qty	18	24	27	33	39
Nominal tractor power	HP	20-50	20-50	20-50	20-50	20-50

### Tools



Flails  
SMW



Flails  
Y DUO

# SMWA rev cf

30-90 HP Ø max. 5 cm [2 inch]

## Reversible linkage for front and rear

Agriculture or greenspace maintenance? All easy ...  
– the mulchers of the SMW series mulch grass, prunings and bushes up to 5 cm [2"] in diameter.

The SMWA rev cf standard version has manual side shift with a two position bolt-on hitch: central and 17 cm [6.7"] to the right.

## Standard version and characteristics

- > Mulches grass and brush up to 5 cm [2"]Ø
- > Working speed 3-10 km/h
- > 3 point linkage cat. 1&2 reversible
- > Side shift with 2 positions: central and 17 cm [6.7"] to the right
- > 540 rpm gearbox with freewheel and through shaft
- > Belt transmission
- > Adjustable rear hood with rubber protection
- > Front protection with metal flaps
- > Support roller 152 mm Ø
- > Standard rotor with SMW flails

## Optional configuration and accessories

- > Rotor with Y flails
- > 750 or 1000 rpm gearbox
- > Gearbox with automatic inverter and double freewheel
- > Additional 3-point linkage
- > Front attachment
- > Hood with rakes
- > Metal front wheels
- > Front protection with chains instead of metal flaps
- > Additional front rubber flap
- > Roller scraper
- > Attachments for undercanopy maintenance (details see separate brochure)



[www.youtube.com/seppimulcher](http://www.youtube.com/seppimulcher)

## Tools



## Specifications · SMWA rev cf

		95 [37]	105 [41]	115 [45]	125 [49]	135 [53]	145 [57]	155 [61]	175 [69]	200 [79]	225 [89]
Working width	cm [inch]	95 [37]	105 [41]	115 [45]	125 [49]	135 [53]	145 [57]	155 [61]	175 [69]	200 [79]	225 [89]
Overall width	cm [inch]	107 [42]	117 [46]	127 [50]	137 [54]	147 [58]	157 [62]	167 [66]	187 [74]	212 [84]	237 [93]
Depth	cm [inch]	90 [35]	90 [35]	90 [35]	90 [35]	90 [35]	90 [35]	90 [35]	90 [35]	90 [35]	90 [35]
Height	cm [inch]	95 [37]	95 [37]	95 [37]	95 [37]	95 [37]	95 [37]	95 [37]	95 [37]	95 [37]	95 [37]
Weight (base value)	kg [lb]	315 [690]	335 [740]	345 [760]	355 [780]	385 [850]	415 [910]	440 [970]	485 [1070]	515 [1140]	535 [1180]
Belts	qty	3	3	3	3	3	3	3	4	4	4
Flails	qty	9	9	12	12	12	15	15	18	21	24
Y flails	qty	15	18	21	24	24	27	27	33	39	45
Nominal tractor power	HP	30-65	30-65	30-65	30-65	30-65	30-65	30-65	40-90	40-90	40-90

### SMWA rev cf · features

Robust chassis made of high tensile steel.

S420

**Gearbox with freewheel and through shaft for front and rear attachment**  
FR FRONT&REAR

**side shift:**  
manual by 2 positions  
17 cm [6.7 inch]

**Metal front wheels (option)**

**Adjustable hood to set the degree of mulching**  
M-FLAP

**Support roller, adjustable in height  
Reinforced bearing and roller**

**Standard rotor with SMW flails**  
Low power consumption at maximum throughput with HELIX ROTOR technology  
HELIX ROTOR

**Optional rotor with Y flails**

**Tempered counter cutters for a perfect mulching result**  
2 COUNTER CUTTERS

# SMWA s

30-90 HP Ø max. 5 cm [2 inch]

## Reversible linkage and hydraulic side shift

Agriculture or greenspace maintenance? All easy ...

– the mulchers of the SMW series mulch grass, prunings and bushes up to 5 cm [2"] in diameter.

The SMWA s can be shifted to the right up to a maximum of 27 cm [10.6"]. The side shift is linear and works even while the machine is mowing, with hydraulic control from the tractor seat.

## Standard version and characteristics

- > Mulches grass and brush up to 5 cm [2"]Ø
- > Working speed 3-10 km/h
- > 3 point linkage cat. 1&2 reversible
- > Linear hydraulic side shift 27 cm [10.6"]
- > 540 rpm gearbox with freewheel and through shaft
- > Belt transmission
- > Adjustable rear hood with rubber protection
- > Front protection with metal flaps
- > Support roller 152 mm Ø
- > Standard rotor with SMW flails

## Optional configuration and accessories

- > Rotor with Y flails
- > 750 or 1000 rpm gearbox
- > Gearbox with automatic inverter and double freewheel
- > Additional 3-point linkage
- > Front attachment
- > Hood with rakes
- > Metal front wheels
- > Rubber wheels instead of roller
- > Front protection with chains instead of metal flaps
- > Additional front rubber flap
- > Roller scraper



YouTube [www.youtube.com/seppimulcher](http://www.youtube.com/seppimulcher)

## Tools



Flails  
SMW



Flails  
Y DUO

## Specifications · SMWAs

		105 [41]	115 [45]	125 [49]	135 [53]	145 [57]	155 [61]	175 [69]	200 [79]
Working width	cm [inch]	105 [41]	115 [45]	125 [49]	135 [53]	145 [57]	155 [61]	175 [69]	200 [79]
Overall width	cm [inch]	117 [46]	127 [50]	137 [54]	147 [58]	157 [62]	167 [66]	187 [74]	212 [84]
Depth	cm [inch]	90 [35]	90 [35]	90 [35]	90 [35]	90 [35]	90 [35]	90 [35]	90 [35]
Height	cm [inch]	105 [41]	105 [41]	105 [41]	105 [41]	105 [41]	105 [41]	105 [41]	105 [41]
Weight (base value)	kg [lb]	360 [790]	380 [830]	390 [850]	420 [920]	440 [960]	455 [970]	505 [1110]	530 [1180]
Belts	qty	3	3	3	3	3	3	4	4
Flails	qty	9	12	12	12	15	15	18	21
Y flails	qty	18	21	24	24	27	27	33	39
Nominal tractor power	HP	30-65	30-65	30-65	30-65	30-65	30-65	40-90	40-90



### SMWA s · features

Robust chassis made of high tensile steel.

S420

Gearbox for front- and rear attachment  
**FR**  
FRONT/REAR

Metal front wheels (option)

Adjustable hood to set the degree of mulching  
**M-FLAP**

Support roller, adjustable in height  
Reinforced bearing and roller

Standard rotor with SMW flails  
Low power consumption at maximum throughput with HELIX ROTOR technology  
**HELIX ROTOR**

Optional rotor with Y flails

Tempered counter cutters for a perfect mulching result  
**2 COUNTER CUTTERS**

Hydraulic side shift:  
linear 27 cm [10.6"]



### SMWA slim · features

Robust chassis made of high tensile steel.

S420

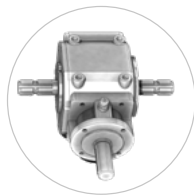

Gearbox for front- and rear attachment

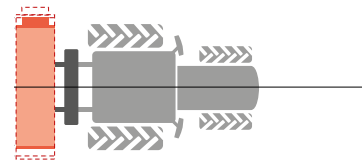

Hydraulic side shift - linear right/left  
2 x 13.5 cm = 27 cm  
[2 x 5 inch = 10 inch]

The power belt chassis is very compact - this allows the machine to work close to the crop

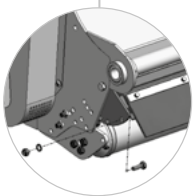

Adjustable hood to set the degree of mulching

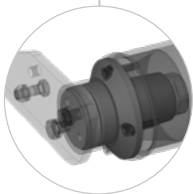

Support roller, adjustable in height  
Reinforced bearing and roller



Tempered counter cutters for a perfect mulching result

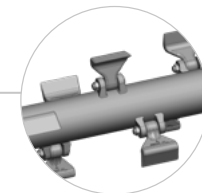

Rotor with SMW flails  
Low power consumption at maximum throughput with HELIX ROTOR technology



# SMWO

30-90 HP Ø max. 5 cm [2 inch]

## Mulcher with generous side shift

Agriculture or greenspace maintenance? All easy ...

– the mulchers of the SMW series mulch grass, prunings and bushes up to 5 cm [2"] in diameter.

The model SMWO is distinguished by an extraordinarily wide side shift to the right. The parallel linkage system allows the machines to work under the trees and close to the crop leaving a much cleaner result.

## Standard version and characteristics

- > Mulches grass and brush up to 5 cm [2"] Ø
- > Working speed 3-10 km/h
- > 3 point rear linkage cat. 1&2
- > Manual parallel linkage side shift P-SHIFT
- > 540 rpm gearbox with freewheel and through shaft
- > Belt transmission
- > Adjustable rear hood with rubber protection
- > Front protection with metal flaps
- > Support roller 152 mm Ø
- > Standard rotor with SMW flails

## Optional configuration and accessories

- > Rotor with Y flails
- > 1000 rpm gearbox
- > Reinforced transmission
- > Hydraulic side shift
- > Hood with rakes
- > Metal front wheels
- > Front protection with chains instead of metal flaps
- > Additional front rubber flap
- > Roller scraper
- > Attachments for undercanopy maintenance (details see separate brochure)



[YouTube www.youtube.com/seppimulcher](https://www.youtube.com/seppimulcher)

## Tools



## Specifications · SMWO

		135 [53]	145 [57]	155 [61]	175 [69]	200 [79]
Working width	cm [inch]	135 [53]	145 [57]	155 [61]	175 [69]	200 [79]
Overall width	cm [inch]	147 [58]	157 [62]	167 [66]	187 [74]	212 [83]
Depth	cm [inch]	120 [47]	120 [47]	120 [47]	120 [47]	120 [47]
Height	cm [inch]	95 [37]	95 [37]	95 [37]	95 [37]	95 [37]
Weight (base value)	kg [lb]	410 [900]	430 [940]	445 [980]	495 [1,090]	520 [1,140]
Belts	qty	3	3	3	4	4
Flails	qty	12	15	15	18	21
Y flails	qty	24	27	27	33	39
Nominal tractor power	HP	30-65	30-65	30-65	40-90	40-90

SMWO · features

Robust chassis made of high tensile steel.

S420

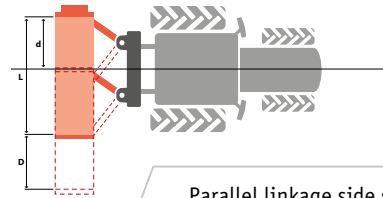

Parallel linkage side shift

L	d	D
135-150	73 cm [29"]	62 cm [24"]
155-200	82 cm [32"]	62 cm [24"]

**P/Shift**

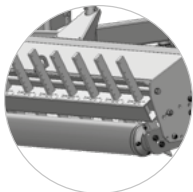

Rake hood complete with rakes (option)

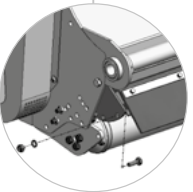

Adjustable hood to set the degree of mulching **M-FLAP**

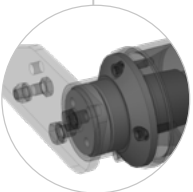

Adjustable roller, Reinforced bearing and roller

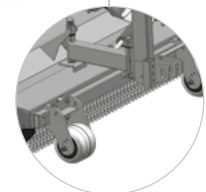

Metal front wheels (option)

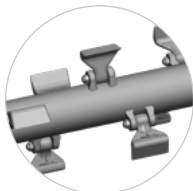

Standard rotor with SMW flails

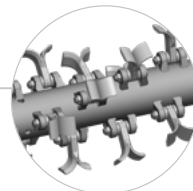

Optional rotor with Y flails



Tempered counter cutters for a perfect mulching result

Low power consumption at maximum throughput with HELIX ROTOR technology



# SMO

50-120 HP Ø max. 7 cm [2.8 inch]

## The expert among the lightweight mulchers with parallel linkage side shift

Road sides, meadows, pastures – the SMO machines satisfy the needs of professionals in the most varied situations with an even clean cut.

The machines of this series mulch grass and brushwood up to 7 cm in diameter.

The model **SMO** is distinguished by an extraordinarily wide side shift to the right. The standard version is equipped with manual side shift, hydraulic side shift is optional. Total side shift is 73 cm [28.7"].

As an option it is also available with central position and side shift to both sides.

### Standard version and characteristics

- > Mulches grass and brush up to 7 cm [2.8"]Ø
- > Working speed 3-10 km/h
- > 3 point rear linkage  
≤225: cat. 1&2, ≥250: cat. 2
- > Manual parallel linkage side shift  
P-SHIFT central/right
- > Gearbox with freewheel and through shaft  
≤200: 540 rpm, ≥225: 1000 rpm
- > Belt transmission
- > Adjustable rear hood with rubber protection
- > Front protection with metal flaps
- > Support roller 152 mm Ø
- > Standard rotor with flails  
≤200: SMO, ≥225: SMW

### Optional configuration and accessories

- > Rotor with Y flails
- > 540 or 1000 rpm gearbox
- > Hydraulic side shift
- > Side shift central/left
- > Hood with rakes
- > Front protection with chains instead of metal flaps
- > Additional front rubber flap
- > Metal front wheels
- > Rubber wheels instead of roller
- > Roller scraper
- > Attachments for undercanopy maintenance (details see separate brochure)



YouTube [www.youtube.com/seppimulcher](http://www.youtube.com/seppimulcher)

### Tools

SMW

SMO



### Specifications · SMO

		125 [49]	150 [59]	175 [69]	200 [79]	225 [89]	250 [98]
Working width	cm [inch]	125 [49]	150 [59]	175 [69]	200 [79]	225 [89]	250 [98]
Overall width	cm [inch]	140 [55]	165 [65]	190 [75]	215 [85]	240 [95]	265 [100]
Depth	cm [inch]	120 [47]	120 [47]	120 [47]	120 [47]	120 [47]	120 [47]
Height	cm [inch]	120 [47]	120 [47]	120 [47]	120 [47]	120 [47]	120 [47]
Weight (base value)	kg [lb]	470 [1,030]	500 [1,100]	550 [1,210]	600 [1,320]	660 [1,450]	720 [1,590]
Belts	qty	4	4	4	4	5	5
Flails	qty	12	15	18	21	24	27
Y flails	qty	24	27	33	39	45	x
Nominal tractor power	HP	50-100	50-100	50-100	50-100	50-120	50-120

S420 · features

Robust chassis made of high tensile steel.

S420

Parallel linkage side shift

**P/Shift**

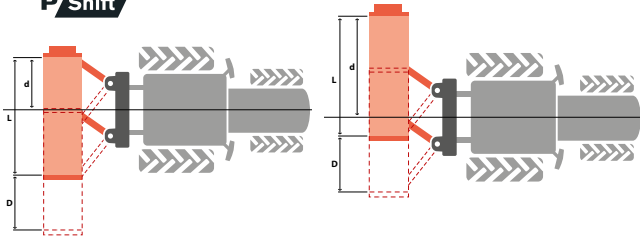

Standard: central/right  
 d = 69 cm [27 inch]  
 D = 73 cm [73 inch]

Option: central/left  
 d = 131 cm [29 inch]  
 D = 73 cm [24 inch]

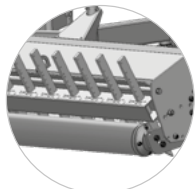
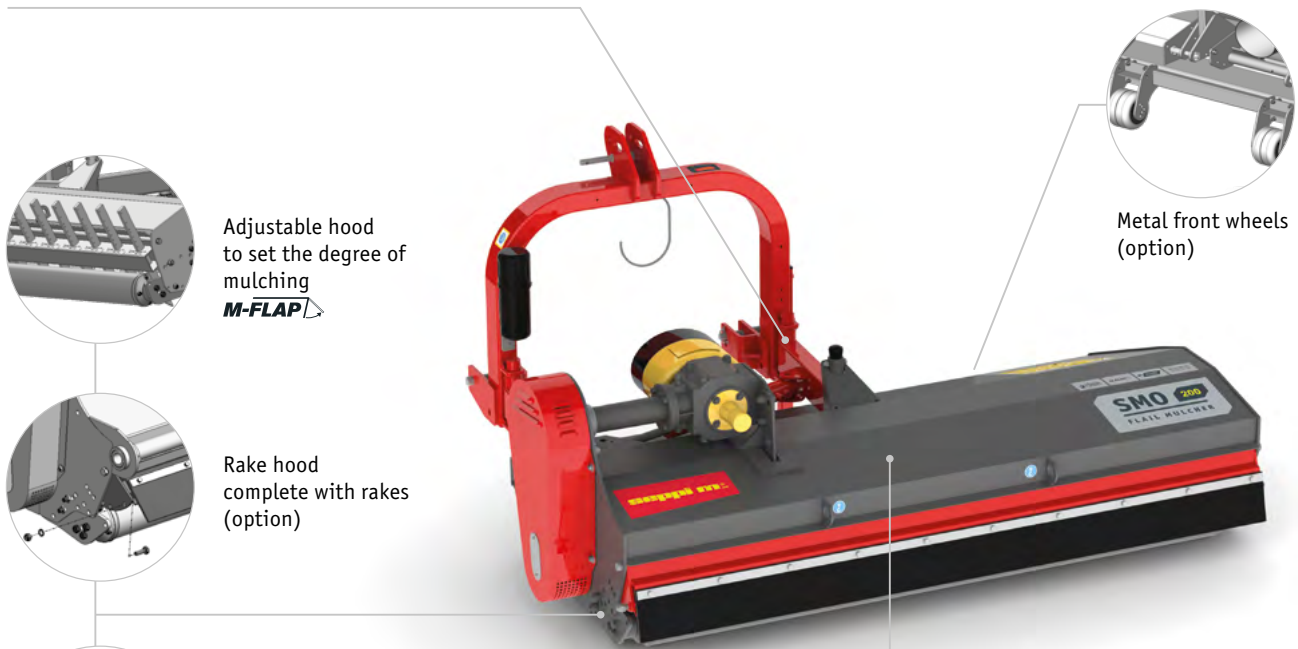

Adjustable hood to set the degree of mulching  
**M-FLAP**

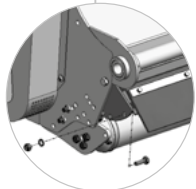

Rake hood complete with rakes (option)

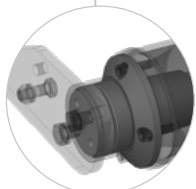

Adjustable support roller, Reinforced bearing and roller

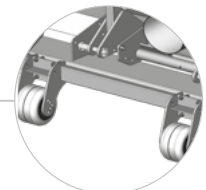

Metal front wheels (option)

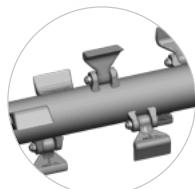

Standard rotor with SMW/SMO flails

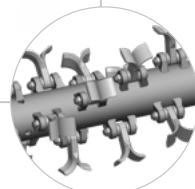

Optional rotor with Y flails



Tempered counter cutters for a perfect mulching result

Low power consumption at maximum throughput with HELIX ROTOR technology



# SMO rev cf

50-120 HP Ø max. 7 cm [2.8 inch]

## The expert among the lightweight mulchers with reversible linkage

Road sides, meadows, pastures – the SMO machines satisfy the needs of professionals in the most varied situations with an even clean cut.

The machines of this series mulch grass and brushwood up to 7 cm in diameter.

The model **SMO rev cf** has a central 3-point linkage. The mulcher is reversible and can be driven in both direction - front and rear.

## Standard version and characteristics

- > Mulches grass and brush up to 7 cm [2.8"]Ø
- > Working speed 3-10 km/h
- > 3 point linkage cat. 2 reversible
- > 1000 rpm gearbox with freewheel and through shaft
- > Belt transmission
- > Adjustable rear hood with rubber protection
- > Front protection with metal flaps
- > Support roller 152 mm Ø
- > Standard rotor with SMO flails

## Optional configuration and accessories

- > Rotor with Y flails
- > 540 rpm gearbox
- > Gearbox with automatic inverter and double freewheel
- > Additional 3-point linkage
- > Front attachment
- > Hood with rakes
- > Front protection with chains instead of metal flaps
- > Additional front rubber flap
- > Metal front wheels
- > Rubber wheels instead of roller
- > Roller scraper
- > Attachments for undercanopy maintenance (details see separate brochure)



[www.youtube.com/seppimulcher](http://www.youtube.com/seppimulcher)

## Tools



## Specifications • SMO rev cf

		150 [59]	175 [69]	200 [79]	225 [89]	250 [98]
Working width	cm [inch]	150 [59]	175 [69]	200 [79]	225 [89]	250 [98]
Overall width	cm [inch]	165 [65]	190 [75]	215 [85]	240 [95]	265 [100]
Depth	cm [inch]	120 [47]	120 [47]	120 [47]	120 [47]	120 [47]
Height	cm [inch]	120 [47]	120 [47]	120 [47]	120 [47]	120 [47]
Weight (base value)	kg [lb]	480 [1,050]	550 [1,210]	600 [1,310]	650 [1,430]	710 [1,560]
Belts	qty	4	4	4	5	5
Flails	qty	15	18	21	24	27
Y flails	qty	27	33	39	45	x
Nominal tractor power	HP	50-100	50-100	50-100	50-120	50-120



### S420 rev cf · features

Robust chassis made of high tensile steel.

S420

Adjustable hood to set the degree of mulching  
**M-FLAP**

Gearbox for front and rear attachment  
**FR FRONTREAR**

Rake hood complete with rakes (option)

Metal front wheels (option)

Adjustable support roller, Reinforced bearing and roller

Standard rotor with SMW/SMO flails

Optional rotor with Y flails

Tempered counter cutters for a perfect mulching result  
**2 COUNTER CUTTERS**

Rubber gauge wheels for uneven ground (instead of roller)

Low power consumption at maximum throughput with HELIX ROTOR technology  
**HELIX ROTOR**

# SMO fh

50-120 HP Ø max. 7 cm [2.8 inch]

## The expert among the lightweight mulchers with innovative linkage

Road sides, meadows, pastures – the SMO machines satisfy the needs of professionals in the most varied situations with an even clean cut.

The machines of this series mulch grass and brushwood up to 7 cm in diameter.

The **SMO fh** is characterized by an innovative, pyramid-shaped 3-point linkage, suitable for front and rear attachment. The top link connection provides high stability and is easily reversed to allow front or rear mount to be achieved without heavy lifting.

## Standard version and characteristics

- > Mulches grass and brush up to 7 cm [2.8"]Ø
- > Working speed 3-10 km/h
- > 3 point linkage cat. 2 reversible
- > Linear hydraulic side shift  
L150-175: 33 cm [13 inch] or  
L200-275: 55 cm [21.6 inch]
- > 1000 rpm gearbox with freewheel and through shaft
- > Belt transmission
- > Adjustable rear hood with rubber protection
- > Front protection with metal flaps
- > Support roller 152 mm Ø
- > Standard rotor with SMO flails

## Optional configuration and accessories

- > Rotor with Y flails
- > 540 rpm gearbox
- > Gearbox with automatic inverter and double freewheel
- > Metal front wheels
- > Front protection with chains instead of metal flaps
- > Rubber wheels instead of roller
- > Additional front rubber flap
- > Roller scraper



[www.youtube.com/seppimulcher](https://www.youtube.com/seppimulcher)

## Tools



## Specifications · SMO fh

		<b>150 [59]</b>	<b>175 [69]</b>	<b>200 [79]</b>	<b>225 [89]</b>	<b>250 [98]</b>	<b>275 [108]</b>
Working width	cm [inch]	150 [59]	175 [69]	200 [79]	225 [89]	250 [98]	275 [108]
Overall width	cm [inch]	165 [65]	190 [75]	215 [85]	240 [95]	265 [105]	280 [115]
Depth	cm [inch]	130 [51]	130 [51]	130 [51]	130 [51]	130 [51]	130 [51]
Height	cm [inch]	120 [47]	120 [47]	120 [47]	120 [47]	120 [47]	120 [47]
Weight (base value)	kg [lb]	660 [1,455]	730 [1,610]	790 [1,740]	850 [1,870]	930 [2,050]	1.020 [2,250]
Belts	qty	4	4	4	5	5	5
Flails	qty	15	18	21	24	27	27
Y flails	qty	27	33	39	45	x	x
Nominal tractor power	HP	50-100	50-100	50-100	50-120	50-120	50-120

SMO fh · features

Robust chassis made of high tensile steel.

S420

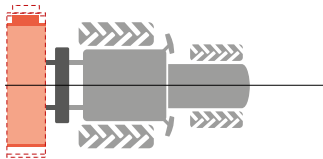

Linear hydraulic side shift

model	each side	total
150-175	16.5 cm [6.5"]	33 cm [13"]
155-200	27.5 cm [10.8"]	55 cm [21.6"]

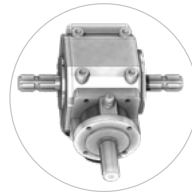

Gearbox for front- and rear attachment

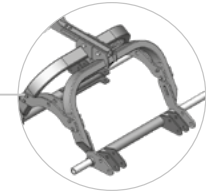

Innovative, pyramid-shaped 3-point linkage with high stability, suitable for front and rear attachment

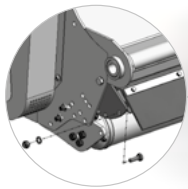
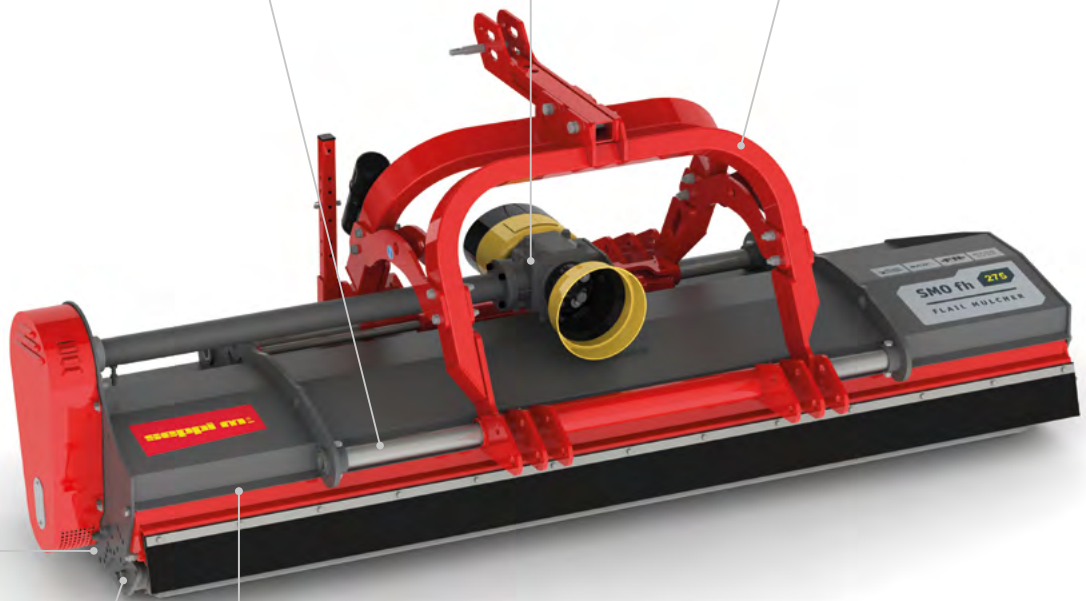

Adjustable hood to set the degree of mulching

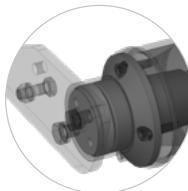

Adjustable support roller, Reinforced bearing and roller



Tempered counter cutters for a perfect mulching result

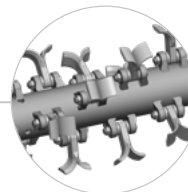

Optional rotor with Y flails

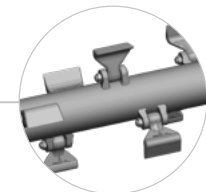

Standard rotor with SMO flails

Low power consumption at maximum throughput with HELIX ROTOR technology



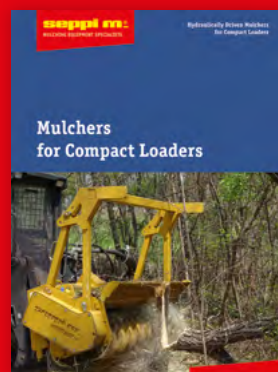
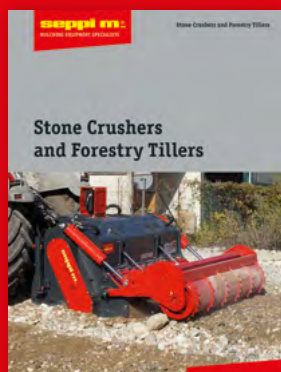
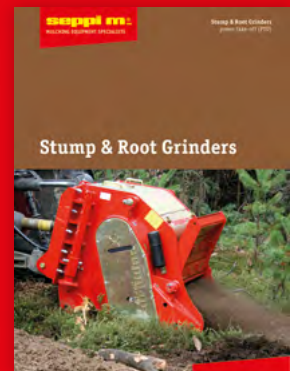
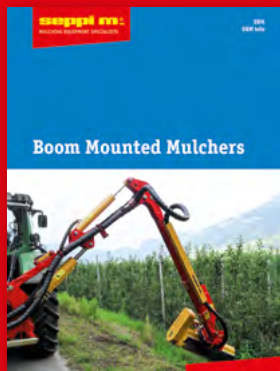
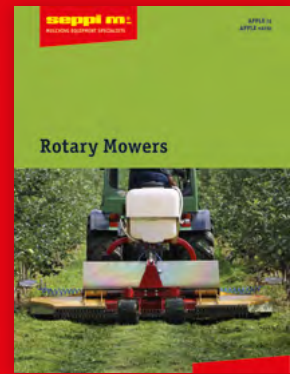
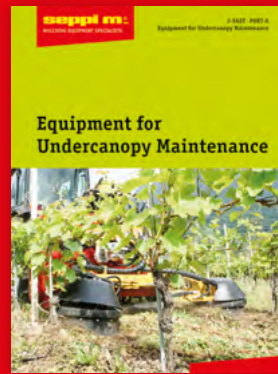
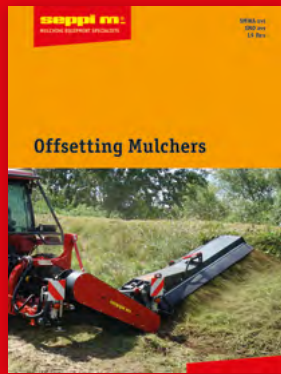

f y i /seppimulcher



**SEPPI M. SpA|AG Italy**  
Zona Artigianale 1 Handwerkerzone  
I-39052 Caldaro|Kaltner (BZ)  
T. +39 0471 963 550  
[www.seppi.com](http://www.seppi.com)

**SEPPI M. USA**  
Division of SEPPI M. SpA  
9077 Gold Park Drive  
West Chester, OH 45011  
T. +1 513 443 6339